



PREMIERE EVENT SPACE IN
AWARD-WINNING OFFICE
PROPERTIES

Washington, DC Metro Area



COVETED SPACE CUSTOMIZED FOR YOU

For those looking to ensure their event is elegant and sophisticated, our spaces are for you. In placing our priority on thoughtful design, we have created some of the most distinguished and coveted buildings in the Washington, DC area, each with unique amenities to enhance how you gather and entertain.

Our spaces are ideal for elevated dinners, corporate happy hours, board meetings, and conferences, yet are customizable to meet your needs. We take pride in providing environments where people – and the events that matter to them – can flourish.



EVENT SPACE OVERVIEW

WASHINGTON, DC



	Signal House // 1255 Union Street NE					1700 New York Ave NW	Midtown Center // 1100 15th Street NW
	Full Buyout	Penthouse	Rooftop Terrace	Conference Space	Recording Studio	Rooftop Terrace	Courtyard
Capacity	369	225	144	73	10	246	770
Rental Rates	\$\$\$	\$\$\$	\$\$	\$	\$	\$\$	\$\$\$
M-F Availability	3PM - 11PM	3PM - 11PM	3PM - 11PM	3PM - 11PM	3PM - 11PM	3PM-11PM	8AM - 9PM
Sat-Sun Availability	6AM - 11PM	6AM - 11PM	6AM - 11PM	6AM - 11PM	6AM - 11PM	6AM - 11PM	7AM - 9PM
Reservation Min.	8 Hrs.	8 Hrs.	8 Hrs.	4 Hrs.	4 Hrs.	3 Hrs.	8 Hrs.

BETHESDA, MD



	The Wilson // 7272 Wisconsin Ave		
	Full Buyout	Penthouse	Rooftop Terrace
Capacity	260	118	142
Rental Rates	\$\$\$	\$\$\$	\$\$\$
M-F Availability	3PM - 11PM	3PM - 11PM	3PM - 11PM
Sat-Sun Availability	6AM - 11PM	6AM - 11PM	6AM - 11PM
Reservation Min.	8 Hrs.	8 Hrs.	6 Hrs.

ARLINGTON, VA

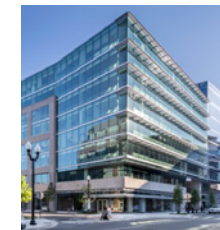

	2311 Wilson Blvd.	
	Conference Room	Rooftop Terrace
Capacity	28	396
Rental Rates	\$	\$\$
M-F Availability	3PM - 11PM	3PM - 11PM
Sat-Sun Availability	6AM - 11PM	6AM - 11PM
Reservation Min.	4 Hrs.	8 Hrs.

SIGNAL HOUSE

1255 UNION STREET NE | WASHINGTON, DC



SIGNAL HOUSE

WASHINGTON, DC

Signal House is a creative office building in the bustling Union Market neighborhood featuring some of the city's best views. Eclectic in its design and amenities, Signal House breaks office paradigms to create an environment that balances professionalism and play.

Ideal for company off-sites and happy hours, especially those meant to inspire creativity.

EVENT SPACES

- Indoor Penthouse
- Rooftop Terrace
- Conference Space
- Recording Studio

SIGNAL HOUSE

EVENT SPACE OVERVIEW

	SIGNAL HOUSE // 1255 UNION STREET NE				
	Full Buyout	Penthouse	Rooftop Terrace	Conference Space	Recording Studio
Capacity	369	225	144	73	10
Rental Rates	\$\$\$	\$\$\$	\$	\$	\$
M-F Availability	3PM - 11PM	3PM - 11PM	3PM - 11PM	3PM - 11PM	3PM - 11PM
Sat-Sun Availability	6AM - 11PM	6AM - 11PM	6AM - 11PM	6AM - 11PM	6AM - 11PM
Reservation Min.	8 Hrs.	8 Hrs.	8 Hrs.	4 Hrs.	4 Hrs.
Demonstration Kitchen	✓	✓			
Catering Kitchen	✓	✓			
Indoor-Outdoor Bar	✓	✓			
Lounge	✓	✓			
DJ Booth	✓	✓			
Karaoke Room	✓	✓			
Conference Lounge	✓	✓		✓	
A/V Capabilities	✓	✓		✓	✓
Flexible Layouts				✓	
Rooftop Access	✓		✓	✓	
Outdoor Grills & Fire Pits	✓		✓		
Capitol Views	✓	✓	✓	✓	
Private Restrooms	✓	✓	✓	✓	✓

SIGNAL HOUSE

PENTHOUSE & ROOFTOP TERRACE FLOOR PLAN

Signal House offers a variety of spaces:

- Indoor Penthouse
- Wrap-Around Rooftop Terrace
- Flexible Conference Space
- Recording Studio

▶ WATCH NOW



Views of Capitol

MORSE STREET NE

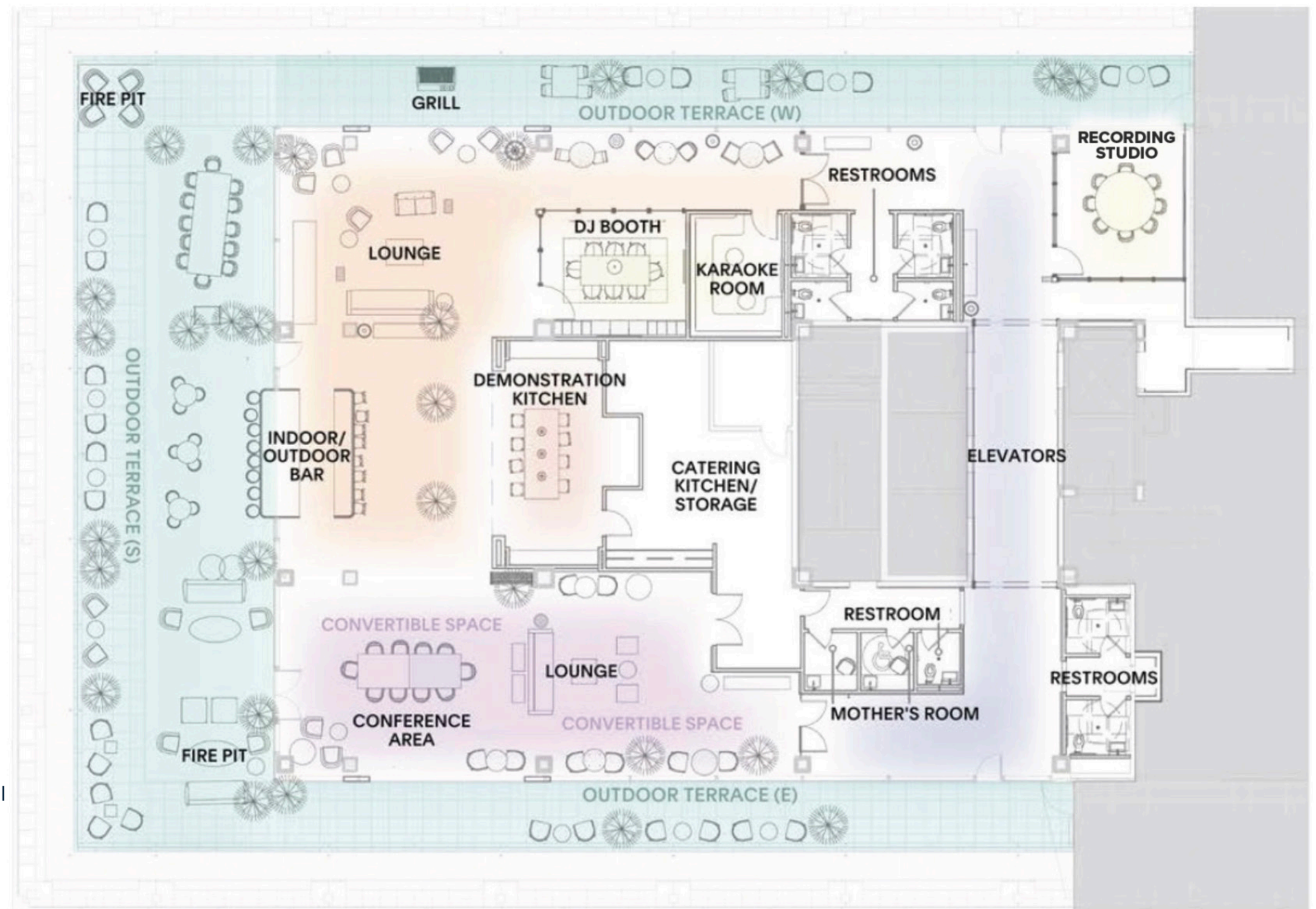

UNION STREET NE



Views of Basilica

SIGNAL HOUSE

INDOOR PENTHOUSE

Capacity	225
Rental Rates	\$\$\$
M-F Availability	3PM - 11PM
Sat-Sun Availability	6AM - 11PM
Reservation Min.	8 Hrs.
Demonstration Kitchen	✓
Catering Kitchen	✓
Indoor-Outdoor Bar	✓
Lounge	✓
DJ Booth	✓
Karaoke Room	✓
Conference Lounge	✓
A/V Capabilities	✓
Flexible Layouts	
Rooftop Access	
Outdoor Grills & Fire Pits	
Capitol Views	✓
Private Restrooms	✓



SIGNAL HOUSE

WRAP-AROUND ROOFTOP TERRACE

Capacity	144
Rental Rates	\$\$
M-F Availability	3PM - 11PM
Sat-Sun Availability	6AM - 11PM
Reservation Min.	8 Hrs.
Demonstration Kitchen	
Catering Kitchen	
Indoor-Outdoor Bar	
Lounge	
DJ Booth	
Karaoke Room	
Conference Lounge	
A/V Capabilities	
Flexible Layouts	
Rooftop Access	✓
Outdoor Grills & Fire Pits	✓
Capitol Views	✓
Private Restrooms	✓



SIGNAL HOUSE

FLEXIBLE CONFERENCE SPACE

Capacity	73
Rental Rates	\$
M-F Availability	3PM - 11PM
Sat-Sun Availability	6AM - 11PM
Reservation Min.	4 Hrs.
Demonstration Kitchen	
Catering Kitchen	
Indoor-Outdoor Bar	
Lounge	
DJ Booth	
Karaoke Room	
Conference Lounge	✓
A/V Capabilities	✓
Flexible Layouts	✓
Rooftop Access	✓
Outdoor Grills & Fire Pits	
Capitol Views	✓
Private Restrooms	✓



SIGNAL HOUSE

CONFERENCE ROOM LAYOUTS

Option A: Boardroom

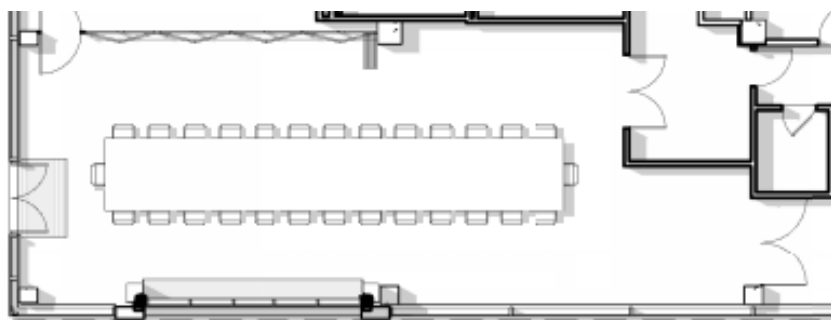

Option B: Classroom

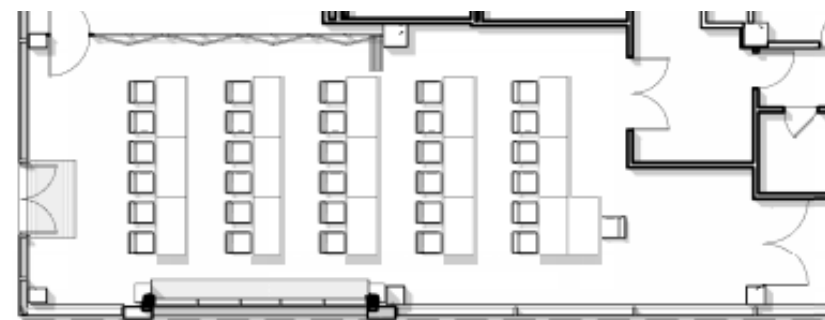

Option C: Auditorium

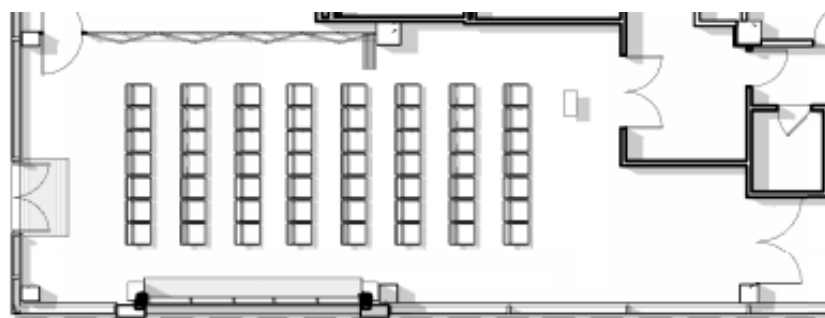

Option D: Dining

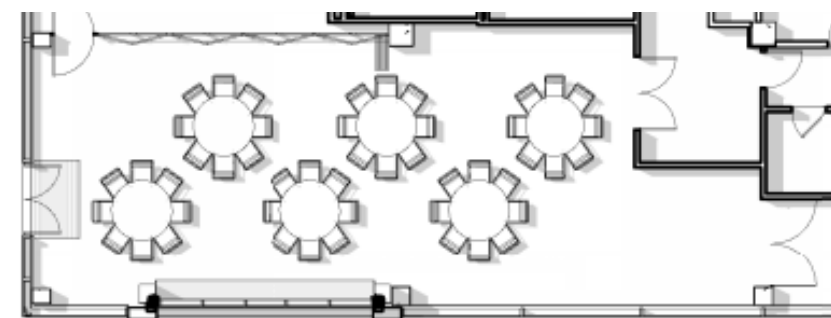

SIGNAL HOUSE

RECORDING STUDIO

Capacity	10
Rental Rates	\$
M-F Availability	3PM - 11PM
Sat-Sun Availability	6AM - 11PM
Reservation Min.	4 Hrs.
Demonstration Kitchen	
Catering Kitchen	
Indoor-Outdoor Bar	
Lounge	
DJ Booth	
Karaoke Room	
Conference Lounge	
A/V Capabilities	✓
Flexible Layouts	
Rooftop Access	
Outdoor Grills & Fire Pits	
Capitol Views	
Private Restrooms	✓



SIGNAL HOUSE

OPERATIONAL SUPPORT & SERVICES

Your reservation fee includes the following operational services:

- Carr Properties Engineer
- Security Guard (1 per 100 Attendees)
- Parking Attendant
- Janitorial

OPERATIONAL AMENITIES

Hosting your event at Signal House is simple with these amenities:

- Below-Grade Parking Garage
- Loading Dock
- Service Elevator
- Back-of-House Catering Entrance

For additional day-of event support, please ask about our add-on Event Coordinator fee.



1700 NEW YORK

1700 NEW YORK AVENUE NW | WASHINGTON, DC



1700 NEW YORK

WASHINGTON, DC

1700 New York stands just 200 yards from the White House, providing remarkable views of the National Mall, Washington Monument, Jefferson Memorial, and Capitol Building. Ideal for photo opportunities, rooftop classes, and evening celebrations, 1700 New York offers the perfect backdrop for those seeking a venue in the heart of the nation's capital.

ROOFTOP HIGHLIGHTS:

- 246-Person Capacity
- Pre-Function Space
- Catering Kitchen & Window
- Retractable Awning
- Modern Furnishings
- Private Restrooms

1700 NEW YORK

ROOFTOP TERRACE FLOOR PLAN

Capacity	246
Rental Rates	\$\$
M-F Availability	3PM - 11PM
Sat-Sun Availability	6AM - 11PM
Reservation Min.	3 Hrs.

▶ WATCH NOW

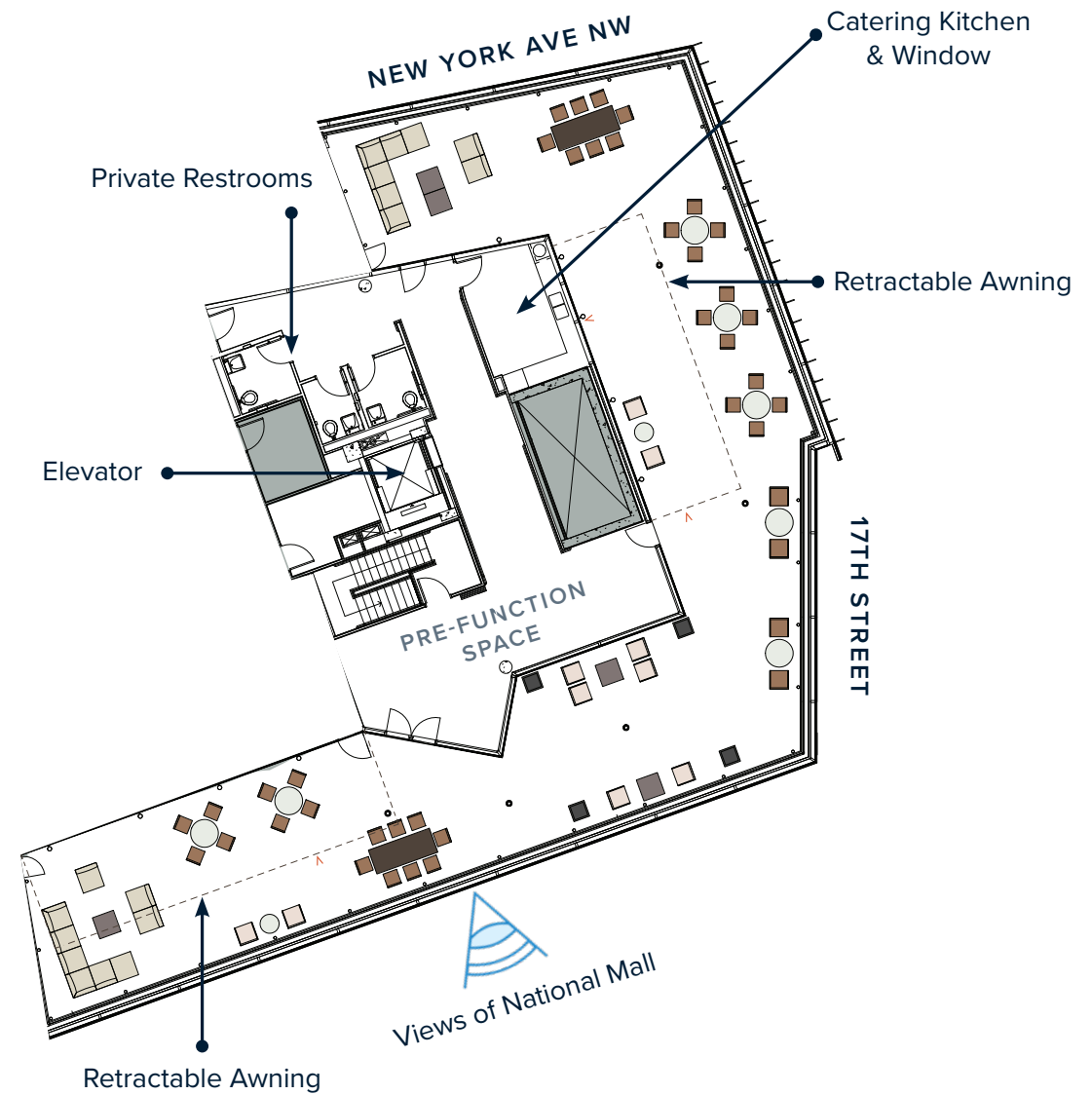



1700 NEW YORK

ROOFTOP TERRACE

The 1700 New York rooftop is the perfect location for engagement or wedding photos, graduation photos, or corporate headshots. Hourly reservations are available.



CARR
MORE THAN AN ADDRESS
WELCOME



1700 NEW YORK ROOFTOP // DAYTIME EVENT





1700 NEW YORK

OPERATIONAL SUPPORT & SERVICES

Your reservation fee includes the following operational services:

- Carr Properties Engineer
- Security Guard (1 per 100 Attendees)
- Parking Attendant
- Janitorial

OPERATIONAL AMENITIES

Hosting your event at 1700 New York is simple with these amenities:

- Below-Grade Parking Garage
- Service Elevator

For additional day-of event support, please ask about our add-on Event Coordinator fee.



An aerial photograph of a modern urban courtyard. The central feature is a large, mature green tree. The courtyard is paved with light-colored, patterned tiles. Several people are walking on the paths. There are two rectangular greenery beds: one with a wooden deck edge and another with a stone wall edge. The courtyard is surrounded by glass-walled buildings with teal-colored vertical accents.

MIDTOWN CENTER

1100 15TH STREET NW | WASHINGTON, DC

MIDTOWN CENTER

WASHINGTON, DC

Known for its iconic bridges, Midtown Center is an architectural statement that houses some of Washington, DC's most coveted restaurants along the courtyard. Ideal for hosting a brand activation, outdoor market, or a company party, Midtown Center's courtyard provides a unique setting for your next seasonal gathering. The courtyard accommodates up to 770 event attendees.

MIDTOWN CENTER

COURTYARD MAP

Midtown Center is a dining destination that features some of the hottest restaurants in Washington, DC. The courtyard is in the center of the action, allowing for highly-coveted and unique catering opportunities.

Capacity	770
Rental Rates	\$\$\$
M-F Availability	8AM - 9PM
Sat-Sun Availability	7AM - 9PM
Reservation Min.	8 Hrs.

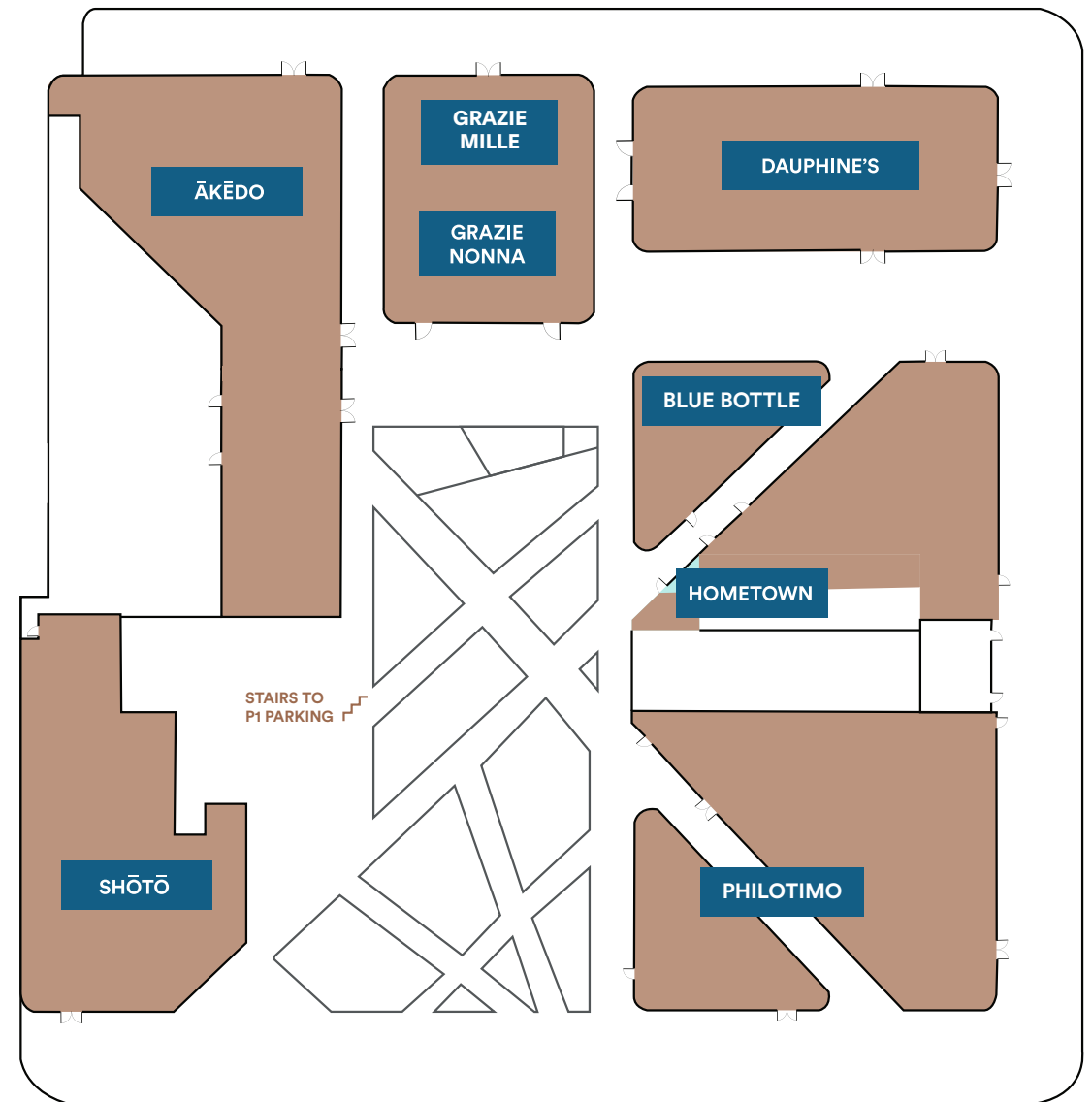

L STREET NW

15TH STREET NW



MIDTOWN CENTER

OPERATIONAL SUPPORT & SERVICES

Your reservation fee includes the following operational services:

- Carr Properties Engineer
- Security Guard (1 per 100 Attendees)
- Parking Attendant
- Janitorial

OPERATIONAL AMENITIES

Hosting your event at Midtown Center is simple with these amenities:

- Below-Grade Parking Garage
- Loading Dock
- Service Elevator

For additional day-of event support, please ask about our add-on Event Coordinator fee.





THE WILSON

7272 WISCONSIN AVENUE | BETHESDA, MD

THE WILSON

BETHESDA, MD

The Wilson's penthouse is perched on the 23rd floor, providing unobstructed views and prime visibility of Bethesda and Washington, DC. The penthouse features a catering kitchen and bar, while the rooftop terrace includes outdoor heaters to ensure your event is comfortable any time of the year.

PENTHOUSE & ROOFTOP HIGHLIGHTS:

- Indoor Capacity: 118
- Outdoor Capacity: 142
- Pre-Function Space
- Flexible Conference Space
- Indoor Bar
- Catering Kitchen
- Private Restrooms

THE WILSON

EVENT SPACE OVERVIEW

	THE WILSON // 7272 WISCONSIN AVE		
	Full Buyout	Penthouse	Rooftop Terrace
Capacity	260	118	142
Rental Rates	\$\$\$	\$\$\$	\$\$\$
M-F Availability	3PM - 11PM	3PM - 11PM	3PM - 11PM
Sat-Sun Availability	6AM - 11PM	6AM - 11PM	6AM - 11PM
Reservation Min.	8 Hrs.	8 Hrs.	6 Hrs.
Pre-Function Space	✓	✓	✓
Catering Kitchen	✓	✓	
Indoor Bar	✓	✓	
Lounge	✓	✓	
A/V Capabilities	✓	✓	
Flexible Layouts	✓	✓	
Rooftop Access	✓		✓
Outdoor Fire Pits & Heaters	✓		✓
DC Views	✓	✓	✓
Private Restrooms	✓	✓	✓

THE WILSON

PENTHOUSE & ROOFTOP TERRACE FLOOR PLAN

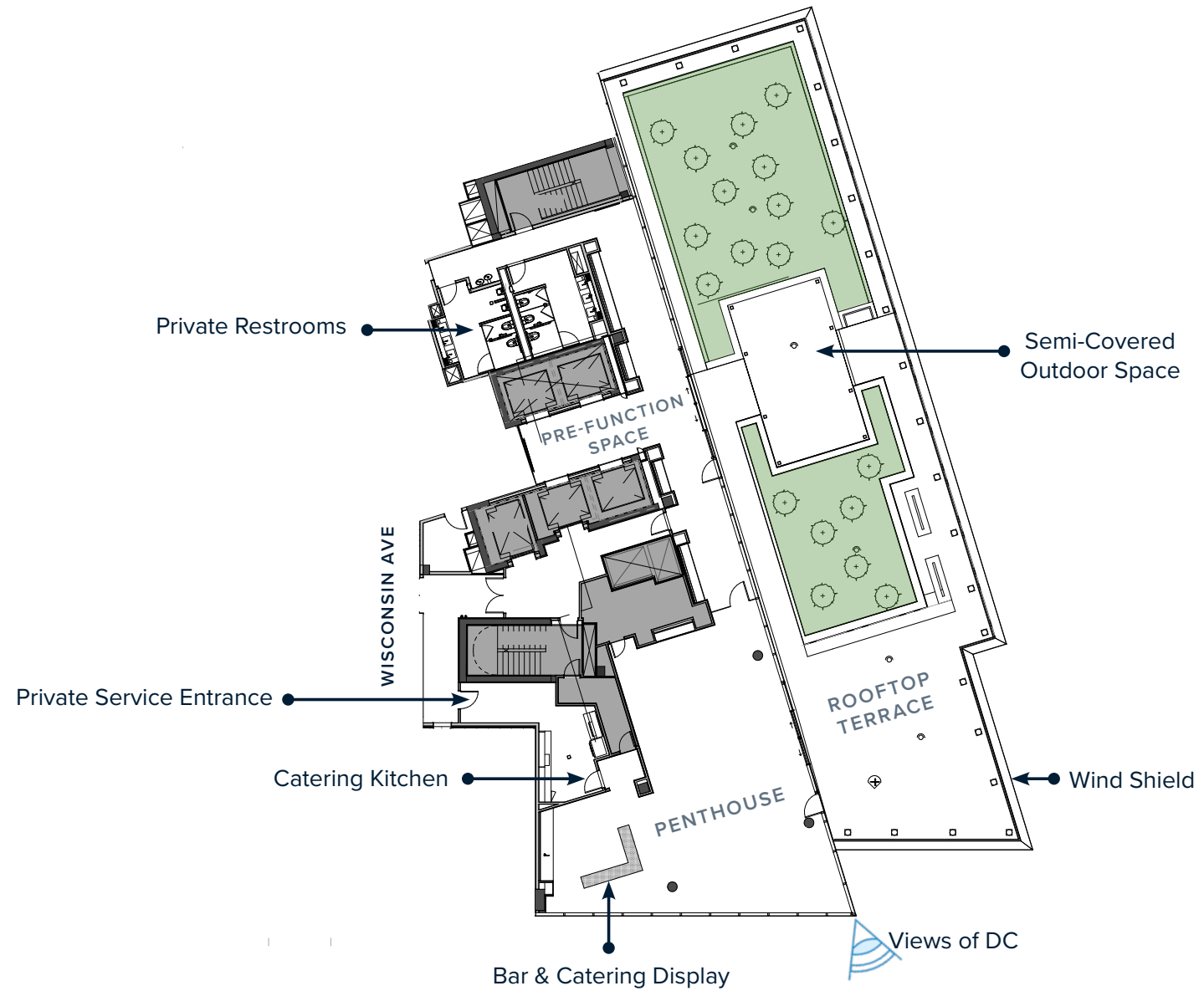

▶ WATCH NOW



THE WILSON

INDOOR PENTHOUSE

Capacity	118
Rental Rates	\$\$\$
M-F Availability	3PM - 11PM
Sat-Sun Availability	6AM - 11PM
Reservation Min.	8 Hrs.
Pre-Function Space	✓
Catering Kitchen	✓
Indoor Bar	✓
Lounge	✓
A/V Capabilities	✓
Flexible Layouts	✓
Rooftop Access	
Outdoor Fire Pits & Heaters	
DC Views	✓
Private Restrooms	✓





THE WILSON

FLEXIBLE CONFERENCE SPACE

SEATED CAPACITY: 24

- Multiple Seating Configurations Available
 - U-Shape
 - Classroom (Chairs Only)
 - Classroom (Tables & Chairs)
 - Boardroom
- Speaking Podium Available
- A/V Capabilities
- Private Restrooms



U-SHAPE LAYOUT



CLASSROOM LAYOUT

THE WILSON

ROOFTOP TERRACE

Capacity	142
Rental Rates	\$\$\$
M-F Availability	3PM - 11PM
Sat-Sun Availability	6AM - 11PM
Reservation Min.	6 Hrs.
Pre-Function Space	✓
Catering Kitchen	
Indoor Bar	
Lounge	
A/V Capabilities	
Flexible Layouts	
Rooftop Access	✓
Outdoor Fire Pits & Heaters	✓
DC Views	✓
Private Restrooms	✓





THE WILSON

OPERATIONAL SUPPORT & SERVICES

Your reservation fee includes the following operational services:

- Carr Properties Engineer
- Security Guard (1 per 100 Attendees)
- Parking Attendant
- Janitorial

OPERATIONAL AMENITIES

Hosting your event at The Wilson is simple with these amenities:

- Below-Grade Parking Garage
- Porte-Cochere
- Loading Dock
- Service Elevator
- Back-of-House Catering Entrance

For additional day-of event support, please ask about our add-on Event Coordinator fee.



HYATT PLACE

HYATT PLACE

2311 WILSON

2311 WILSON BOULEVARD | ARLINGTON, VA



2311 WILSON

ARLINGTON, VA

2311 Wilson offers an expansive indoor conference room and the largest rooftop space in our Washington, DC-area events portfolio. In a transit-oriented location, 2311 Wilson is perfect for those prioritizing accessibility. For Five Coffee Roasters provides a full selection of healthy snacks, small bites, and speciality coffee drinks on the ground floor, making catering an event here easy. The spaces at 2311 Wilson are ideal for large meetings, happy hours, and rooftop events.

2311 WILSON

CONFERENCE ROOM

Capacity	28
Rental Rates	\$
M-F Availability	3PM - 11PM
Sat-Sun Availability	6AM - 11PM
Reservation Min.	4 Hrs.
Pre-Function Space	✓
Dry Bar	✓
A/V Capabilities	✓
Flexible Layouts	✓
Rooftop Access	
Catering Kitchen & Window	
Outdoor Fans	
Natural Light & Views	✓
Private Restrooms	✓

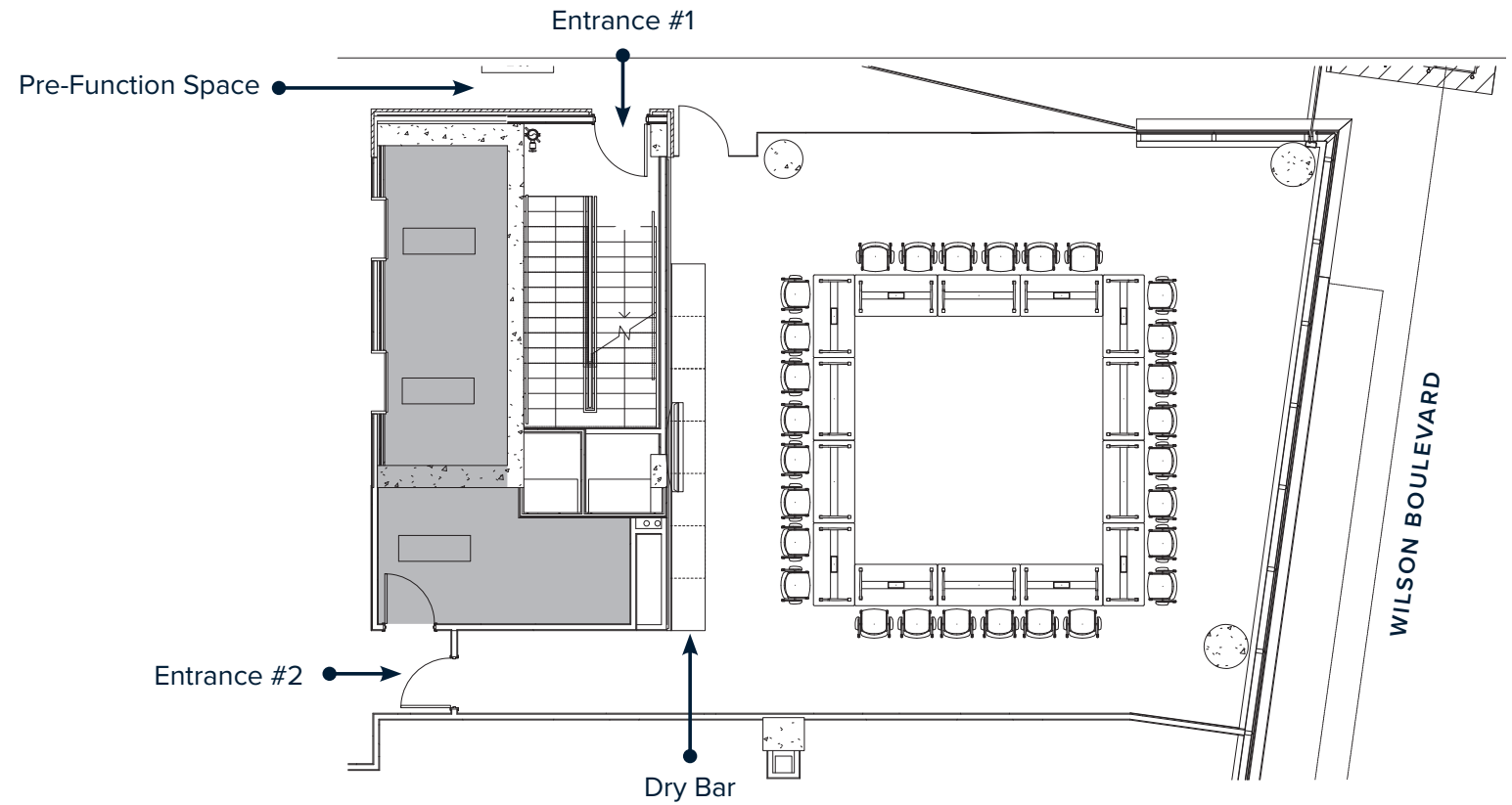

2311 WILSON

ROOFTOP TERRACE FLOOR PLAN

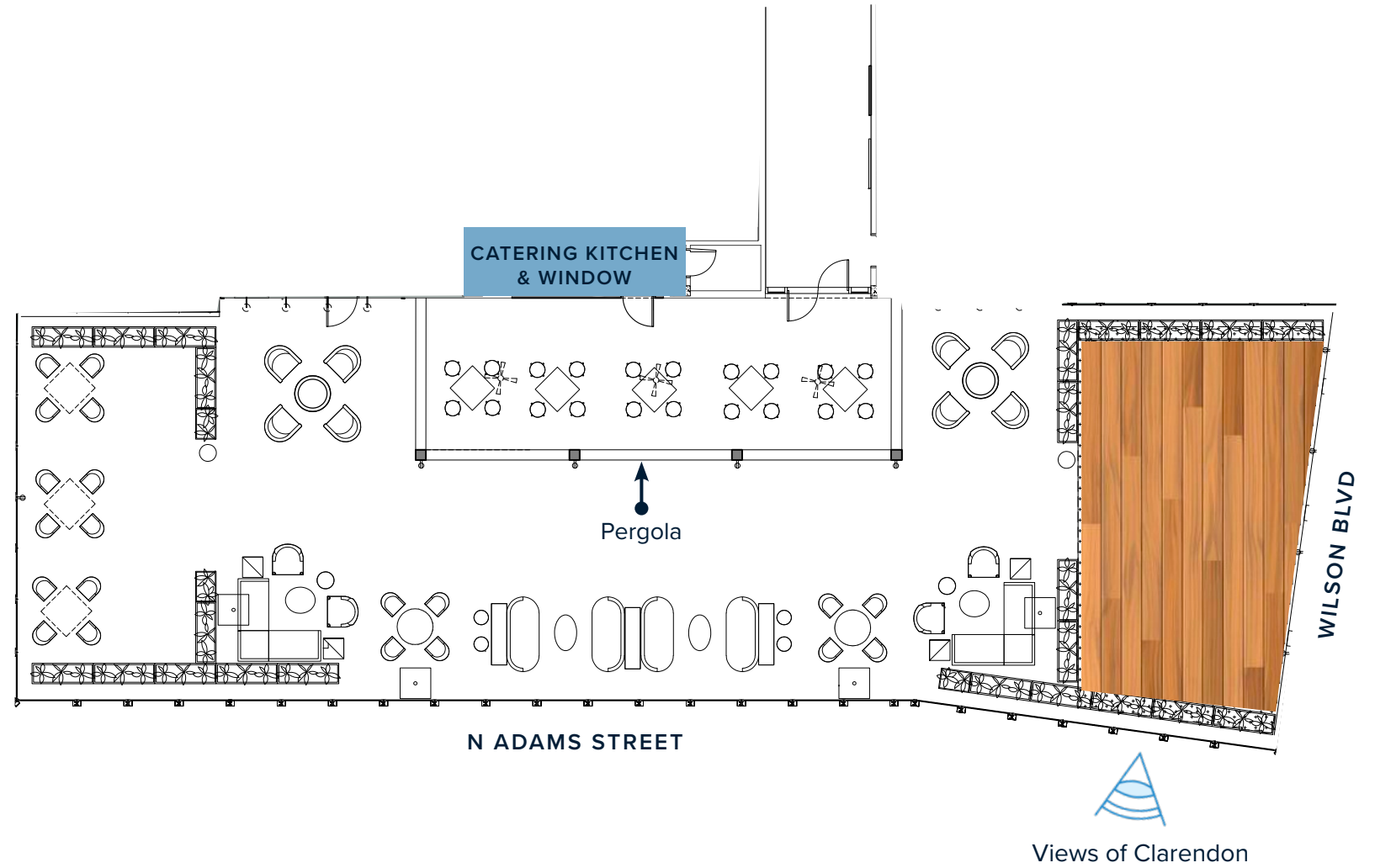

2311 WILSON

ROOFTOP TERRACE

Capacity	396
Rental Rates	\$\$
M-F Availability	3PM - 11PM
Sat-Sun Availability	6AM - 11PM
Reservation Min.	8 Hrs.
Pre-Function Space	
Dry Bar	
A/V Capabilities	
Flexible Layouts	
Rooftop Access	✓
Catering Kitchen & Window	✓
Outdoor Fans	✓
Natural Light & Views	✓
Private Restrooms	✓





2311 WILSON

OPERATIONAL SUPPORT & SERVICES

Your reservation fee includes the following operational services:

- Carr Properties Engineer
- Security Guard (1 per 100 Attendees)
- Parking Attendant
- Janitorial

OPERATIONAL AMENITIES

Hosting your event at 2311 Wilson is simple with these amenities:

- Below-Grade Parking Garage
- Loading Dock
- Service Elevator
- Back-of-House Catering Entrance

For additional day-of event support, please ask about our add-on Event Coordinator fee.



FREQUENTLY ASKED QUESTIONS

? WHAT DOES THE RENTAL FEE INCLUDE?

The rental fee includes the cost of the event space, as well as the operational services supplied by the Carr+ Events team, including: security, janitorial, an on-site engineer, and parking attendant.

? ARE CARR+ EVENTS SPACES FURNISHED?

Yes, all Carr+ Events spaces come fully furnished. Please note, Carr+ Events does not supply any additional event rentals or decor. The event host is welcome to bring in additional furniture or decor, pending a compliant COI from the furniture/ decor vendor. We encourage you to look at our Preferred Vendor List to find additional services or rental assistance for your event.

? DOES CARR+ EVENTS PROVIDE DAY-OF EVENT STAFF?

Included in your rental fee is an on-site engineer, security, janitorial, and a parking attendant. For an additional fee, Carr+ Events can provide a day-of event coordinator to support your event.

? IS PARKING AVAILABLE?

On-site parking is available at all properties. Individual parking rates apply. Times and rates vary by property. A parking attendant is included in the cost of your event rental.

? DOES CARR+ EVENTS OFFER ON-SITE CATERING?

We do not offer on-site catering, however, we encourage you to review our Preferred Vendor List for catering suggestions, as well as other vendor recommendations.

? DO I HAVE TO USE A VENDOR FROM THE PREFERRED VENDOR LIST?

You are not required to use a vendor from our Preferred Vendor List, but any vendor used must be approved by Carr+ Events and must supply a compliant COI.

? DOES CARR+ EVENTS REQUIRE TENTING FOR INCLEMENT WEATHER?

If there is a 60% or higher chance of rain one week out from your event, we require that you tent any outdoor space. Carr+ Events will supply you with our approved tent vendor and confirm all logistic for your space.

? CAN I TOUR A CARR+ EVENTS SPACE BEFORE I CONFIRM MY RESERVATION?

Yes, the Carr + Events team would be happy to meet you for an in-person or virtual tour of any of our spaces. Please complete the inquiry form on carrplusevents.com to schedule your tour.

? WHAT FORMS OF PAYMENT DO YOU ACCEPT?

We accept check, wire transfer or ACH. A 50% non-refundable deposit is required to reserve your event date. The balance of your fee will be due two weeks prior to your event date.

TO BOOK YOUR NEXT EVENT, PLEASE VISIT CARRPLUSEVENTS.COM



CARR+
EVENTS

PREMIERE EVENT SPACE
IN AWARD-WINNING OFFICE PROPERTIES

carrplusevents.com